

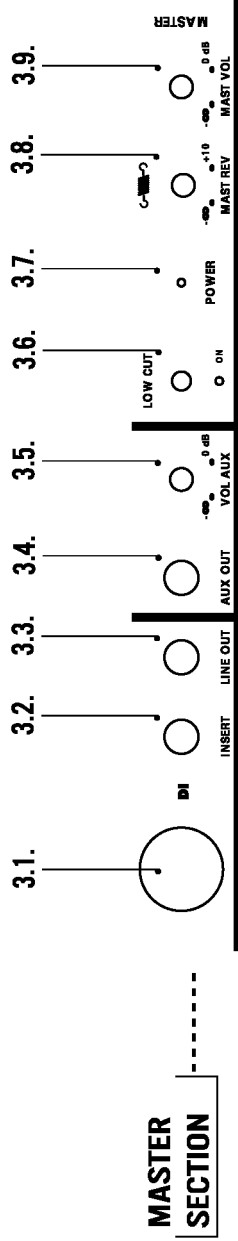

DAVID

DAVID - OVERVIEW

REAR PANEL

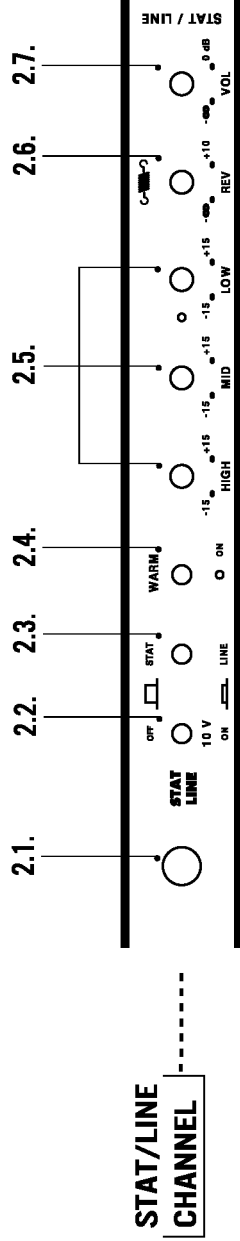
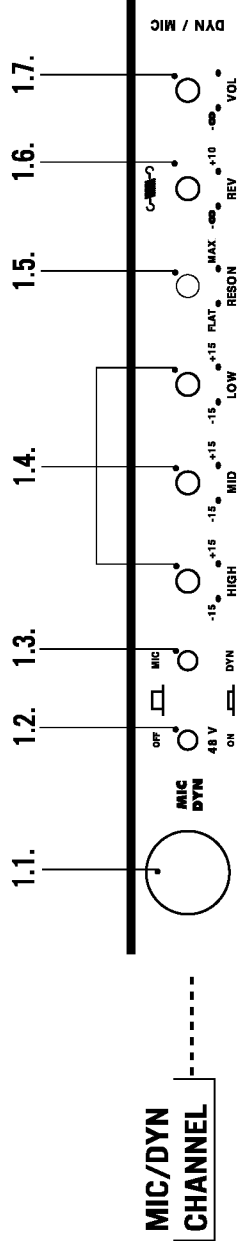
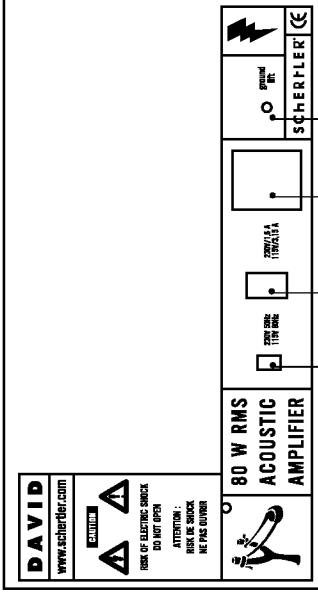

INDEX

SUBJECT	PAGE
INTRODUCTION	1
MIC/DYN CHANNEL	2
STAT/LINE CHANNEL	3
MASTER SECTION	4
REAR PANEL	5
TEC. DESCRIPTION	6
ACCESSORIES	7

DAVID UTILITIES

CONNECTING YOUR BLUESTICK®

BLUESTICK® set:

Connect to the **STAT IN - LINE IN** with the 10V switch disconnected.

DO NOT CONNECT TO THE DYN IN INPUT (this input is very sensitive)

BLUESTICK® Marine:

Connect to the **STAT IN - LINE IN** input with the 10V switch connected.

DO NOT CONNECT TO THE DYN IN INPUT (this input is very sensitive)

CONNECTING HIGH-IMPEDANCE SIGNALS:

To connect any passive Piezo transducer use the "Active Driver Cable" accessory.

Connect to the **STAT IN - LINE IN** input with the 10V switch connected.

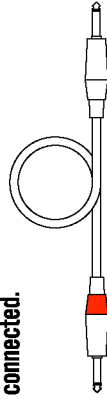

1. MIC: enables to plug in a condenser microphone (the 48V "phantom power" key must be activated) or a dynamic microphone.

DYN: enables to plug in a SCHERTLER DYN series microphone (electrodynamic microphone) connected to an instrument.

2. STAT: enables to plug in a BLUESTICK® Marine by turning on the 10V power supply (you can also use any SCHERTLER STAT series microphone.)

LINE IN: enables to plug in a keyboard or any other instrument with a pre-amplified output signal.

DI OUT: your signal can be sent to external systems such as the SCHERTLER OPERA mixer.

4. If you wish to have more bass for your UNICO, connect the LINE OUT output to the SCHERTLER PUB-380 active bass extension. Press the LOW CUT key to avoid any phase troubles.

5. To adjust the volume more easily you can use the "UNICO VOLUME CONTROL PEDAL" through the INSERT.

6. If you need a monitor to further amplify your sound, send the signal from the AUX OUT output to the SCHERTLER SIDE active loudspeaker (180W) or to the SCHERTLER PUB-280 bass extension (280W) and adjust the output volume using the AUX SEND potentiometer.

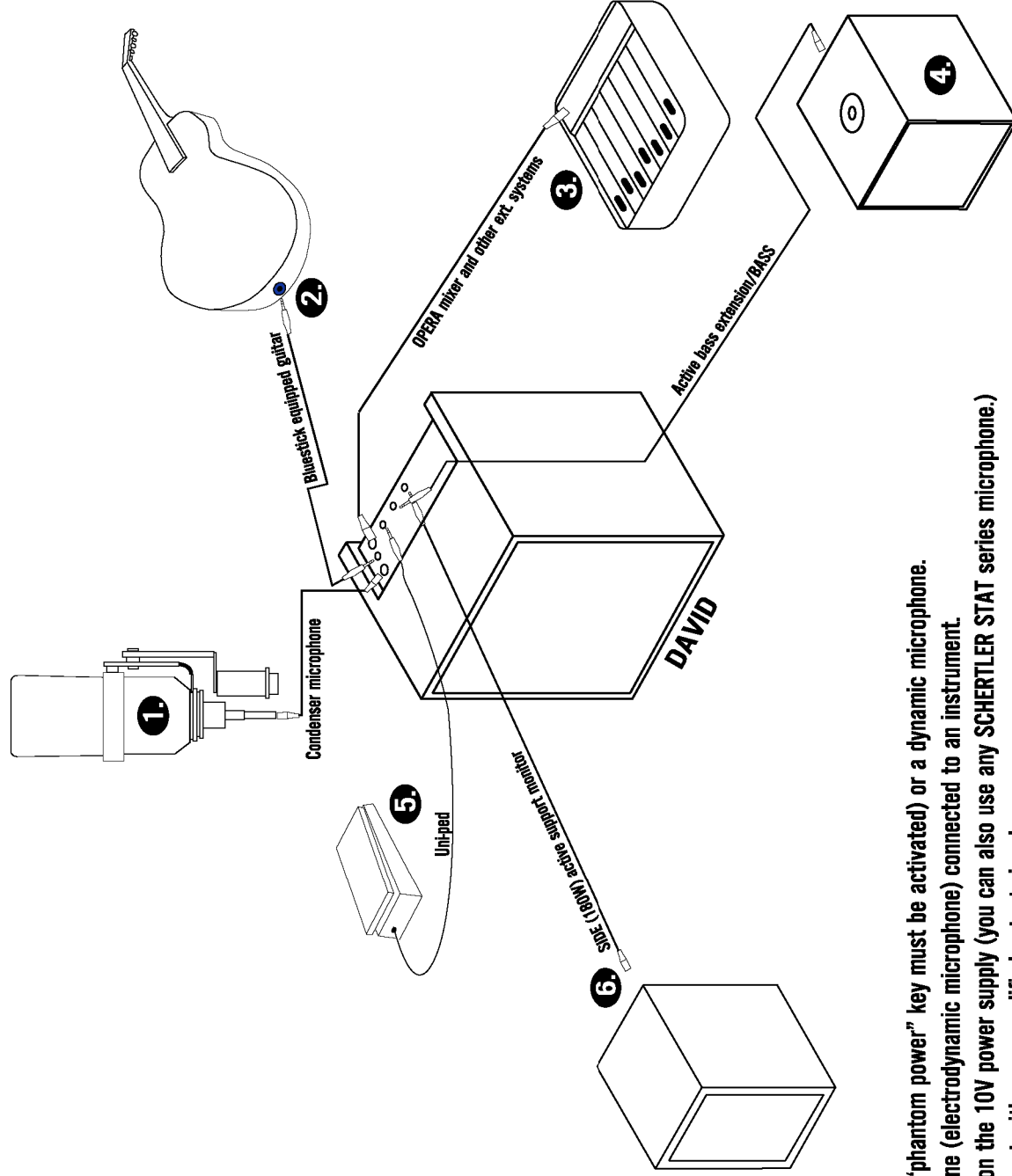

INTRODUCTION

Schertler is now pleased to introduce David, a more compact acoustic instrument combo amplifier. Featuring high attention to quality and sound, David is perfect for the artist requiring only two input channels. From preamplifiers to loudspeakers, all components were selected for their natural and accurate response. Two power amps with an active crossover supply 50 watts to the 6" woofer and 30 watts to the 1" dome tweeter. The result is velvety, clear harmonics with a controlled, strong low end (down to 40 Hz).

The technology of biamplification produces a very transparent sound as well as providing maximum efficiency by properly matching amplifiers to loudspeakers. In addition, each power amplifier features limiter circuitry to deliver secure speaker protection.

Amplifiers are built with bipolar transistors (no MOS-FET) and are powered by a robust, traditional power supply (toroidal transformer).

David's innovative CLASS-A circuitry and built-in analog spring reverberation deliver the warm, smooth and musical sound that acoustic musicians have been seeking. Whether your instrument is guitar or violin, mandolin or cello, listen to your playing through David.

You'll be amazed!

Additional features: Phantom 48V, DI out, insert, aux out, the capability to connect an additional active speaker like the Schertler 300 Watt PUB 280, or, for bass players, our bass extension PUB 380, for which the UNICO has an integrated low cut at 150Hz.

Compare the DAVID with any other acoustic amp on the market!!

Schertler® TEAM

WARNING



- Please read this manual carefully before operating the DAVID. Keep the manual for future reference.
- Pay due care not to pour liquids on the device, nor operate it in excessively humid conditions.
- Do not install the DAVID near sources of intense heat, expose it to direct sunlight, nor position it in dusty environments without protection.
- Ensure that the supply voltage is not higher than the one stated on the rear panel.
- Never use the equipment if the cable or the electrical plug is damaged (if necessary change them or have them carefully repaired).
- To prevent any induced disturbance in the DAVID, do not install near transformers, TV sets, RF transmitters, electric motors or any source of electric power.
- Do not direct the microphones towards the speakers as this could cause acoustic feedback (Larsen effect) which could damage the loudspeakers.
- To avoid damage, only use the original connection cables.
- Never connect any output and input channels of the device. It could create dangerous loops.
- Never connect any audio outlet of the DAVID with any source of electricity.
- Never use solvent based cleaning agents, such as acetone or alcohol to clean the equipment, as this will damage the external finish and the printing on the panels.
- In case of malfunction of any device in the system, contact the nearest SCHERTLER® technical assistance center or a specialized center. Do not attempt repairs yourself.

1.0. MIC / DYN

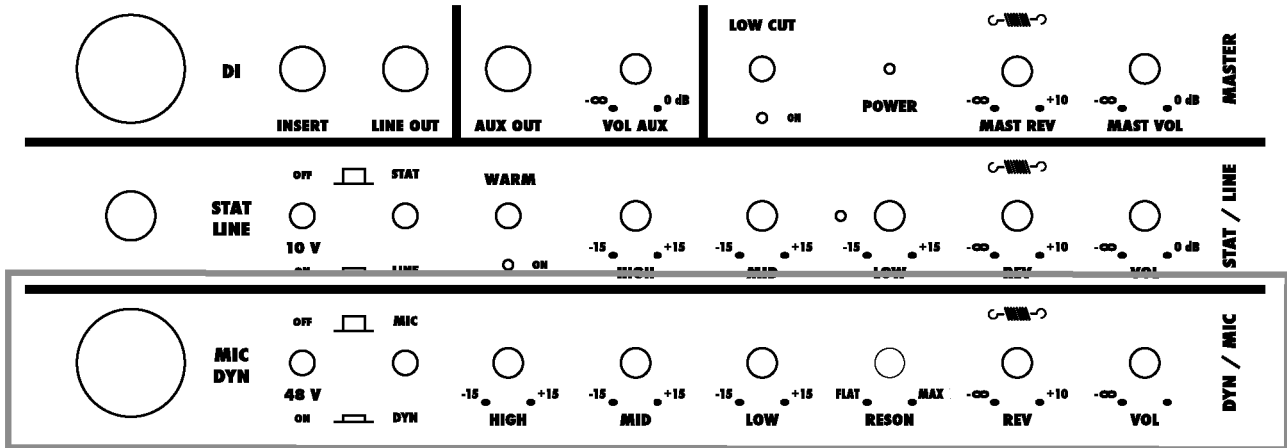

1.1. MIC / DYN (Input)

This input is electronically balanced for XLR type connections. If selected, the MIC position (see 1.3.) is perfect for vocal condensers or dynamic microphones, and if it's in DYN position (see 1.3.) this input becomes perfect for SCHERTLER's DYN microphones. The nominal value of impedance is 4.7 Kohm.

1.2. 48V

Phantom power supplies the XLR connector with 48 Volts for powering condenser microphones.

1.3. MIC - DYN (switch)

Sensitivity switch. It optimizes sensitivity based upon your needs (see 1.1.)

1.4. HIGH - MID - LOW

These controls are devoted to high - medium - low frequency regulation. Offering cut and boost of ± 15 dB, they allow a wide range of tonal variations to be explored. When the controls are positioned centrally there is no cut or boost of the selected frequency band.

1.5. RESON (Resonance filter)

Resonance (Notch) filter attenuates (cuts) the frequency of 180Hz, to reduce low-frequency feedback.

- Left: no attenuation (flat)

- Right: maximum attenuation

1.6. REV (Spring reverb)

This rotary control sets the level of the spring reverb on the individual channel.

1.7. VOL (Volume)

This rotary control regulates the channel volume.

2.0. STAT / LINE

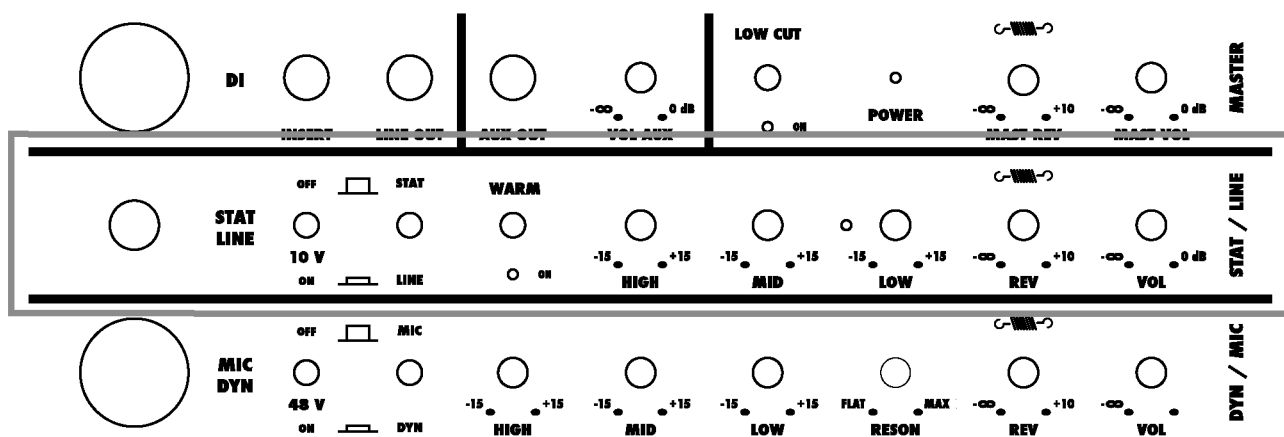

2.1. STAT / LINE (Input)

This input is intended for unbalanced 1/4" jack connectors. If the STAT position is selected (see 2.3.) this input is perfect for high-level audio signals such as E-Guitars or bass and similar instruments. In LINE position (see 2.3.) this input is perfect for high-impedance signals like CD players and other devices. The nominal input impedance is 100 Kohm.

The switchable 10V Phantom power supply provides power to electrostatic condenser microphones such as Schertler's Bluestick Marine acoustic guitar pickups and Schertler's STAT series electrostatic transducers. This input also allows to connect all passive piezo sources to the "Active Driver Cable" by pressing the 10V switch.

2.2. 10V

Provides switchable 10V Phantom Power to the STAT/LINE input.

2.3. STAT - LINE (Switch)

Sensitivity switch. It optimizes sensitivity based upon your needs (see 2.1.)

2.4. WARM

When engaged, this low-pass filter damps higher frequencies to produce a warmer sound when using bridge-mounted pickups such as the chertler STAT-Series transducers for violin, cello and double bass.

2.5. HIGH – MID – LOW

These controls are devoted to high – medium – low frequency regulation. Offering cut and boost of ± 15 dB, they allow a wide range of tonal variations to be explored. When the controls are positioned centrally there is no cut or boost of the selected frequency band.

2.6. REV (Riverbero a molla)

This rotary control sets the level of the spring reverb on the individual channel.

2.7. VOL (Volume)

This rotary control regulates the channel volume.

3.0. MASTER SECTION

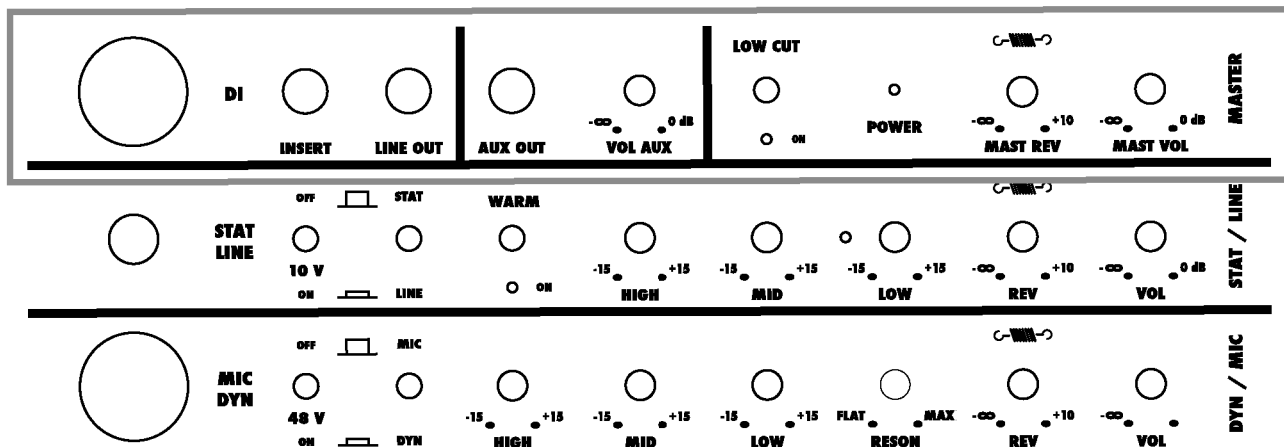

3.1. DI OUT

General output. XLR balanced type connector for connection of external systems. The output volume **does not depend** on the regulation of the MASTER volume.

3.2. INSERT

This 1/4" stereo Jack enables the input - output connection of an external device connected in series to all the outputs. For example, the insert may be used to connect a compressor, equalizer, noise gate, etc.

3.3. LINE OUT

This unbalanced 1/4" Jack enables the connection of external systems. The output volume **depends** on the regulation of the MASTER volume.

3.4. AUX OUT

This unbalanced 1/4" Jack connects to the input of external systems such as effects devices. The output volume is PRE MASTER and POST (internal) REVERB. It depends on the regulation of the AUX SEND volume.

3.5. VOL AUX

This control sets the output level on the AUX OUT.

3.6. LOW CUT

When engaged, this filter cuts all the frequencies below 150Hz and the LED illuminates.

UNICO will then be a mid-high frequency system. All the outputs (Aux Out, Line Out, DI Out) continue to operate in full range.

3.7. POWER (Blu led)

This LED (when lit) indicates that the device is ON.

3.8. MASTER REV (Spring reverb)

This control regulates the general level of the spring reverb, common to all channels. The amount of the effect can be regulated individually for the single channel through the dedicated controls.

"THE ULTIMATE REVERB" is designed and engineered to provide unequalled performance. It employs innovative new circuit technology. The reverb tank is shielded to reduce noise from stray magnetic fields. The spring reverb uses only the finest components to obtain the highest quality reproduction. The spring is driven by a pure class-A (constant current) circuit and captured by a balanced microphone preamp.

3.9. VOL

Controls overall system volume.

4.0. REAR PANEL

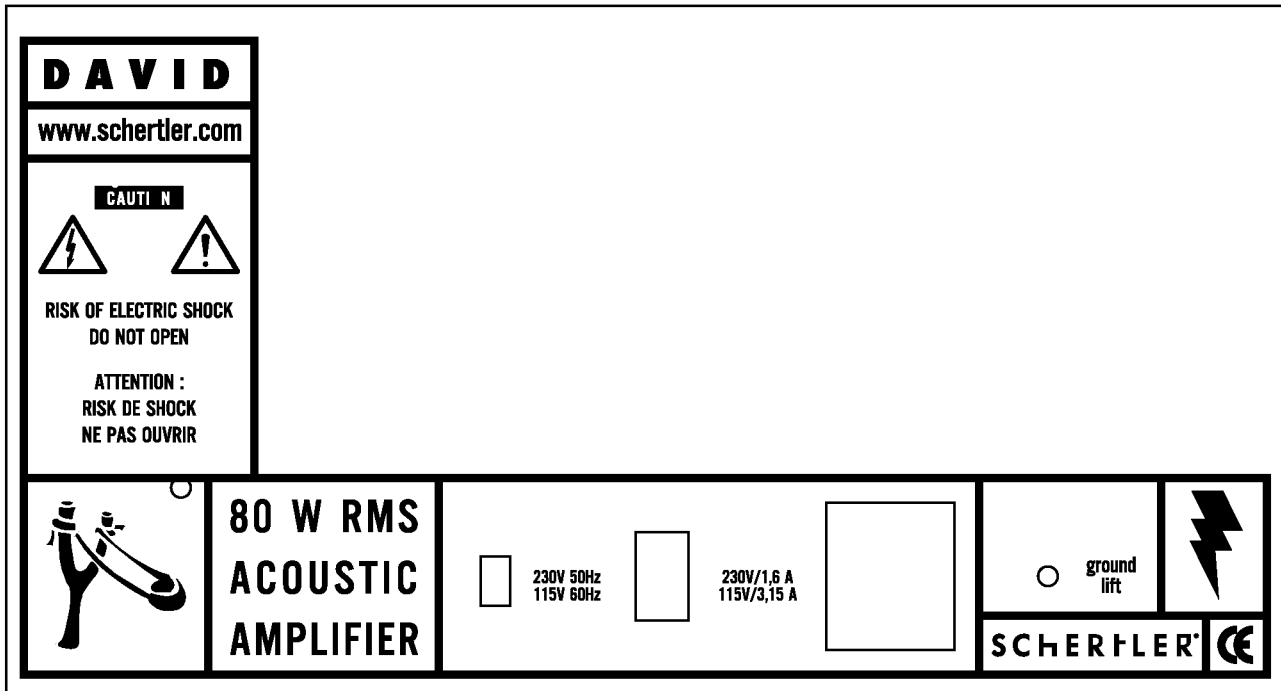

4.1. POWER SWITCH

This switch changes the main power voltage from 230vAC to 115vAC.

4.2. POWER ON/OFF

System ON/OFF switch.

4.3. MAIN POWER CONNECTION

Connection to mains (230vAC/115vAC -, 50-60Hz). PLEASE ENSURE PROPER VOLTAGE ! Use the original connection cable.

DANGER
**HIGH
VOLTAGE**

4.4. GROUND LIFT

Switch for connecting-disconnecting the ground. To be used in case of mains originated hum.

FUSE FOR 115V - 3.15A

FUSE FOR 230V - 1.6A

5.0. TECHNICAL DESCRIPTION

5.1 DESCRIPTION

Box two way, bass reflex

5.2. ENCLOSURE SECTION

Construction = Plywood
Weight = Kg 9
Dimensions = cm 30x34x24.5

5.3. AMPLIFIED SPEAKER SECTION

Frequency resp. = 40Hz - 22KHz
Sensitivity = (1W -1m) 91dB
SPL max = 106dB

5.4. TECHNICAL SPECIFICATIONS INPUTS

MIC/DYN

MICROPHONE INPUT:

Connector = XLR balanced / JACK unbalanced
Sensitivity = - 35dB
Impedance = 4.7 Kohm

DYN INPUT:

Connector = XLR balanced / JACK unbalanced
Sensitivity = - 28dB
Impedance = 4.7 Kohm

STAT/LINE

STAT INPUT:

Connector = JACK mono unbalanced
Sensitivity = - 28dB
Impedance = 100 Kohm

LINE INPUT:

Connector = JACK mono unbalanced
Sensitivity = - 16dB
Impedance = 100 Kohm

5.5. TECHNICAL SPECIFICATIONS OUTPUTS

LINE OUT:

Connector = JACK mono sbilanciato
Level = - 12dBm
Impedance = 200ohm

DI - OUT:

Connector = XLR bilanciato
Level = - 20dBm
Impedance = 200ohm

AUX OUT:

Connector = JACK mono sbilanciato
Level = 0dBm
Impedance = 200ohm

5.6. INTERNAL EFFECT (spring reverb)

Frequency resp. = 200Hz - 10KHz
Delay time = c.a. 30ms
Reverb time = c.a. 2s

5.7. COMPONENTS

Woofers = 6"
Tweeter = Doome 1"
Cross-over = Attivo, 24 dB/ottava
Costruzione = Plywood
Amplificatore = BIAMPLIFIED 50W+30W RMS
= 0.1% THD
= 8ohm
= 180W Peak

5.8. INSERT

Stereo Jack unbalanced
TIP - SEND
RING - RETURN
SLEEVE - GROUND

5.9. FUSE

230V = 1.6A
115V = 3.15A

DAVID ACCESSORIES

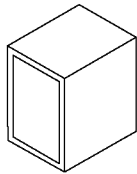

SIDE- ACTIVE 150W + 35W BIAMPLIFIED BOX

ORDER CODE: SIDE

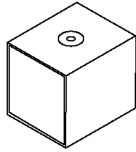

BASS 200- ACTIVE 200W SW BOX

ORDER CODE: BASS-200

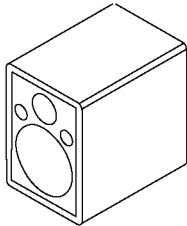

PUB 2/280- ACTIVE 280W BIAMPLIFIED BOX

ORDER CODE: PUB-280-230-H	230V
ORDER CODE: PUB-280-115-H	115V

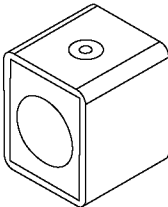

PUB 1/380- ACTIVE 380W SW BOX

ORDER CODE: PUB-380-230-H	230V
ORDER CODE: PUB-380-115-H	115V

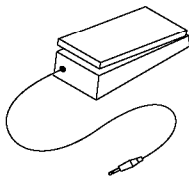

UNICO VOLUME PEDAL

ORDER CODE: UNI-PED



HIGH IMPEDANCE ACTIVE DRIVER CABLE

ORDER CODE: CA-ADRIVER-4

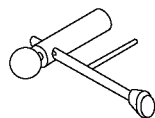

STAND MONITOR

ORDER CODE: S1-MONITOR

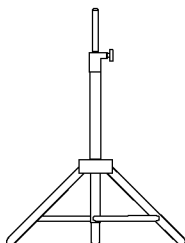

STAND SINGLE

ORDER CODE: S3-SINGLE

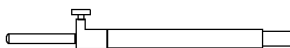

STAND COMBO

ORDER CODE: S2-COMBO

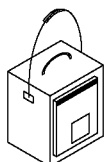

BAG DAVID

ORDER CODE: BAG-DAVID

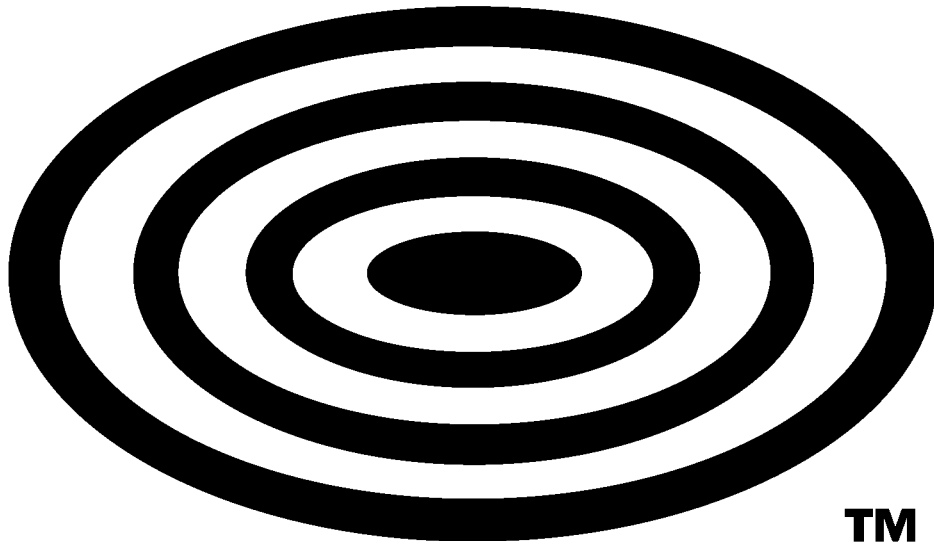

TM

SCHERTLER SA

Via Beroldingen 18,
6850 Mendrisio, Switzerland
Tel. +41 91 630 07 10
Fax +41 91 630 07 11

web-page: www.schertler.com
SWISS e-mail: info@schertler.com
USA e-mail: info@schertlerusa.com